

DWG NO 127-3410A SH 1 REV D

REVISIONS

REV.	ECN	DESCRIPTION	BY/DATE	CHK	APPR
A	13869	INITIAL RELEASE. SAME AS REV X5.	KG 11/29/17	LN	DV
B	14088	UPDATED REGISTERED TRADEMARK	DP 03/12/18	MH	LN
C	14112	MOUNTING SCREW: IS: 10-32 X 1.25 WAS: 8-32 X 1.25	AM 3/22/18	DP	DV
D	14912	UPDATED ISOMETRIC VIEW TO SHOW SENSITIVITY ARROW	DA, 02/21/19	KG	LN

DETAIL A
SCALE 4:1

PIN 6 BOOT RESET

PIN 5 GATE

PIN 4 GND RET

PIN 3 POWER

PIN 2 CAN LOW

PIN 1 CAN HIGH

MASTER
Chatsworth, CA ONLY IF IN RED

TITLE:
**OUTLINE/INSTALLATION DWG,
MODEL 3410A**

SIZE	CAGE CODE	DWG NO	REV
B	2W033	127-3410A	D

SCALE: 3:2

SHEET 1 OF 1

UNLESS OTHERWISE SPECIFIED:
INTERPRET DIM & TOL PER
ASME Y14.5M - 1994.
REMOVE BURRS.
COUNTERSINK INTERNAL THDS
90° TO MAJOR DIA.
CHAM EXT THDS 45° TO MINOR DIA.
THD LENGTHS AND DEPTHS ARE FOR
MIN FULL THDS.
DIMENSIONS APPLY AFTER FINISHING.

ALL MACHINED SURFACES.
TOTAL RUNOUT WITHIN .005.
BREAK SHARP EDGES .005 TO .010.
MACHINED FILLET RADII .005 TO .015.
WELDING SYMBOLS PER AWS A2.4.
ABBREVIATIONS PER MIL-STD-12.

UNLESS OTHERWISE SPECIFIED:
DIMENSIONS ARE IN INCHES.
DIMENSIONS IN BRACKETS [] ARE IN
MILLIMETERS TOLERANCES ARE:

DECIMALS	METRIC	ANGLES
.XX ± .03	.X ± 0.8	° ± 1°
.XXX ± .010	.XX ± 0.25	

APPROVALS

ORIG	LN	DATE
CHK	LN	08/04/15
APP	DV	11/29/17
		12/08/17

DO NOT SCALE DRAWING

THIRD ANGLE PROJECTION

Model Number 3410A	PERFORMANCE SPECIFICATION			DOC NO PS3410A
		SINGLE AXIS ACCELEROMETER, CAN OUTPUT		REV C, ECN 14512, 09/18/18



- HIGH FREQUENCY PERFORMANCE
- ELECTRICALLY ISOLATED
- EXCELLENT LINEARITY
- HERMETICALLY SEALED
- CAN OUTPUT

PHYSICAL

Weight, Max.
Mounting provision
Connector
Housing Material

ENGLISH		SI	
4.4	oz	125	grams
10-32 UNF-2A		10-32 UNF-2A	
D38999/25YA35PN		D38999/25YA35PN	
300 Series S.S.		300 Series S.S.	

PERFORMANCE (SYSTEM)

Input range
Maximum bandwidth
Available sampling rates
Resonant Frequency
Equivalent Electrical Noise Floor
Linearity [1]
Maximum Transverse Sensitivity
Strain Sensitivity @ 250 µε
Available Vibration Analysis:

Asynchronous

±500	g	±4905	m/s ²
1 to 15,500	Hz	1 to 15500	Hz
1.625 / 3.25 / 6.5 / 13 / 26 / 52	kHz	1.625 / 3.25 / 6.5 / 13 / 26 / 52	kHz
>40	kHz	>40	kHz
0.015	Grms	0.147	m/s ² rms
± 2%	% F.S.	± 2%	% F.S.
5	%	5	%
0.010	g/µε	0.10	m/s ² /µε
Time Data RMS		Time Data RMS	
Time Data Skew		Time Data Skew	
Absolute/Relative Spectral Peak		Absolute/Relative Spectral Peak	
Absolute/Relative Spectral Energy		Absolute/Relative Spectral Energy	
Raw Vibration Data		Raw Vibration Data	
Raw Spectral Data		Raw Spectral Data	

Synchronous

TSA Waveform	TSA Waveform
Order Domain Data	Order Domain Data
Order Domain Amplitude	Order Domain Amplitude
Order Domain Phase	Order Domain Phase

ENVIRONMENTAL

Maximum Vibration
Maximum Shock
Temperature Range
Seal

±600	g's, peak	±5886	m/s ² peak
±2000	g's, peak	±19620	m/s ² peak
-40 to 250	°F	-40 to 121	°C
Hermetic		Hermetic	

Electrical

Power Consumption
Compliance Voltage Range
Electrical Isolation, Ground Wire to Case

<0.4	W	<0.4	W
10 to 32	Volts	10 to 32	Volts
10	MΩ, min	10	MΩ, min

This family also includes:

Supplied Accessories:

- 1) Accredited calibration certificate (ISO 17025)
- 3) Mounting screw, 10-32 x 1.25, Model 6543A4

Notes:

- [1] Measured using zero-based straight line method, % of F.S. or any lesser range.
- [2] Do not apply power to this system without current limiting, 65 mA MAX.
- [3] In the interest of constant product improvement, we reserve the right to change specifications without notice

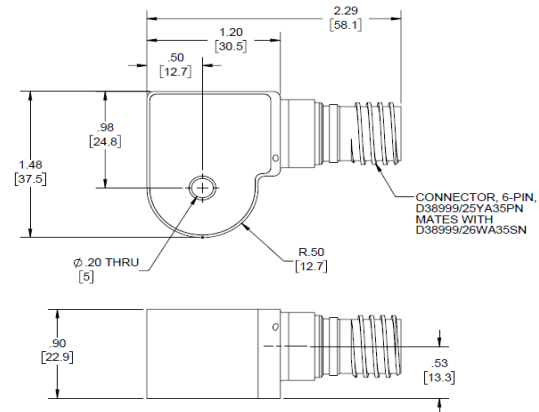
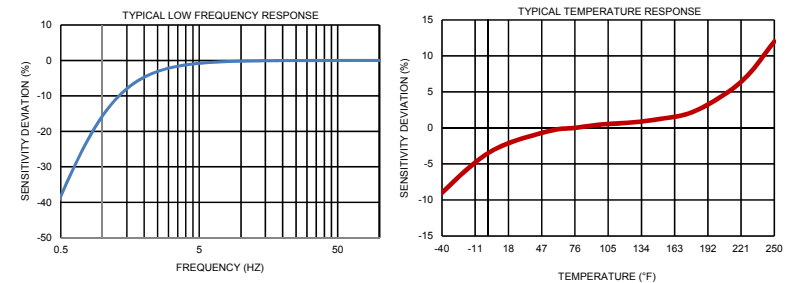

Units on the line drawing are in inches, units in brackets are in millimeters. Refer to 127-3409A for more information.



21592 Marilla Street, Chatsworth, California 91311 Phone: 818.700.7818 Fax: 818.700.7880 www.dytran.com
For permission to reprint this content, please contact info@dytran.com

