

Product Model: **MM121A Series**

Piezoelectric IEPE Accelerometer

Version: A Date: 17/3/2022

Sensor Feature:

Shear design to reduce the influence of the environment on the signal.

Using wide temperature coefficient ceramic material

Stable output in high and low temperatures

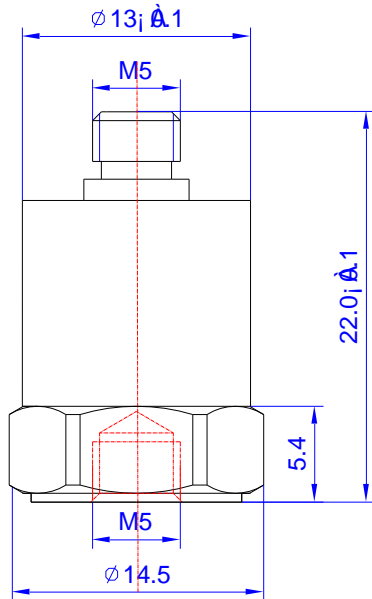

Model	MM121A-100
Sensitivity ($\pm 10\%$)	100 mV/g
Measurement Range	± 50 g
Resolution	0.5 mg rms
Frequency Range (± 1 dB)	0.5-10,000 Hz
Resonant Frequency	~ 25 kHz
Non-linearity	$\leq 1\%$
Temperature Range	-40 \sim +121 $^{\circ}\text{C}$
Transverse Sensitivity	$\leq 5\%$
Excitation Voltage	+18-+28 VDC
Excitation Current	2 - 10 mA
Output Impedance	$< 100 \Omega$
Output Bias Voltage	11 \pm 1.5 VDC
Sensing Element/Geometry	Ceramic/Shear
Size mm	As left figure
Weight	~ 18 g
Mounting	M5 (female)
Housing Material	Stainless Steel

Frequency Response

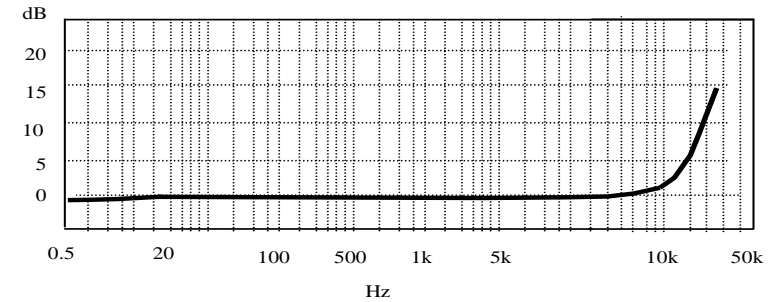

Temperature Response

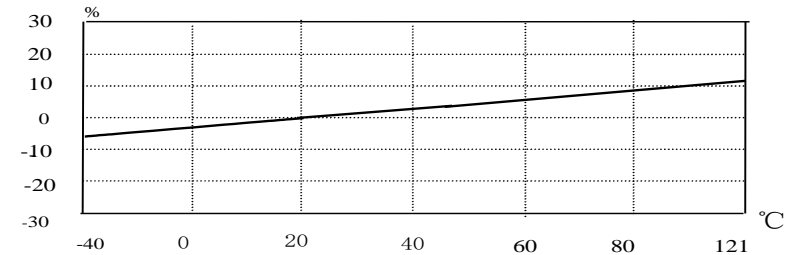

Metromatics

ABN: 47 007 346 287

Accessories

- 2 Metre Coaxial Shielded Cable 1ea
- Certificate of inspection 1ea + M5 Stud 1ea

Remark

Output Connector – M5 Top

25 Flinders Parade, North Lakes QLD 4509, AUSTRALIA

www.metromatics.com.au

sales@metromatics.com.au

Brisbane: +61 7 3868 4255

Sydney: +61 2 9460 4355

Melbourne: +61 3 9872 4592

Adelaide: +61 8 8343 8516