

Product Model: **MM162A Series**

## Miniature Single Axis IEPE Accelerometer

Version: A Date: 17/3/2022

**Sensor Features:**

- Ceramic material with wide temperature coefficient
- Stable output in high and low temperature
- Shear design to reduce the influence of the environment on the signal

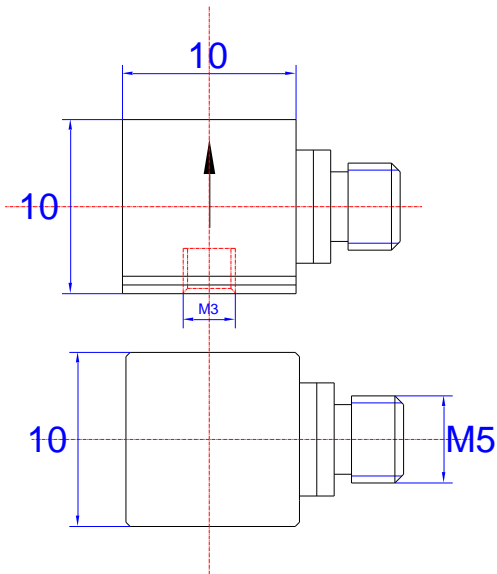

| Model                                  | MM162A-100              |
|--|-------------------------|
| Sensitivity ( $\pm 10\%$ )             | 100 mV/g                |
| Measurement Range                      | $\pm 50$ g              |
| Frequency Range ( $\pm 1$ dB)          | 1-10,000 Hz             |
| Resolution                             | 1 mg rms                |
| Resonant Frequency                     | $\sim 35$ kHz           |
| Transverse Sensitivity + Non Linearity | $\leq 5\%$ / $\leq 1\%$ |
| Temperature Range                      | $-40 \sim +121$ °C      |
| Excitation Voltage                     | $+18 \sim +28$ VDC      |
| Excitation Current                     | 2 to $+10$ mA           |
| Sensing Element                        | Ceramic/Shear           |
| Output Impedance                       | $< 100$ $\Omega$        |
| Output Bias Voltage                    | $11 \pm 1.5$ VDC        |
| Housing Material                       | Stainless Steel         |
| Size mm                                | As left figure          |
| Weight                                 | $\sim 7.5$ g            |
| Output Connector                       | M5 Side                 |
| Mounting                               | M3 (Female) or Adhesive |

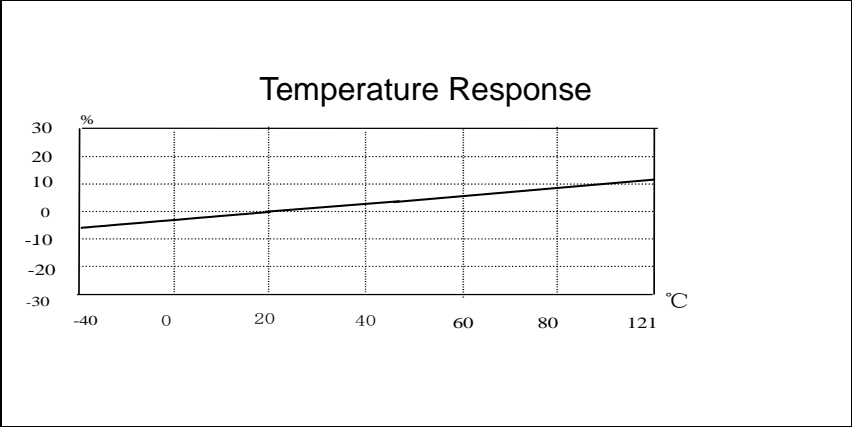
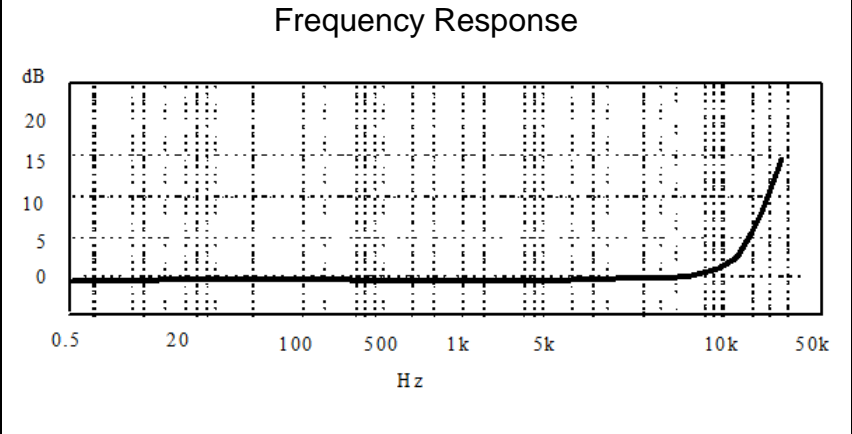

**Accessories**

- Certificate of inspection 1ea + 2M Coaxial shielded cable 1ea + M3 stud 1 ea M3 (Female) Mounting Type

**Remark**



### Metromatics

ABN: 47 007 346 287

25 Flinders Parade, North Lakes QLD 4509, AUSTRALIA  
[www.metromatics.com.au](http://www.metromatics.com.au)      [sales@metromatics.com.au](mailto:sales@metromatics.com.au)  
 Brisbane: +61 7 3868 4255    |    Sydney: +61 2 9460 4355  
 Melbourne: +61 3 9872 4592    |    Adelaide: +61 8 8343 8516