

Product Model: **MM242A Series**

General Purpose Triaxial PE Accelerometer

Version: A Date: 17/3/2022

Sensor Features:

Stable output in high and low temperatures
 Uses a wide temperature coefficient ceramic material
 Shear Design to reduce the influence of the environment on the signal

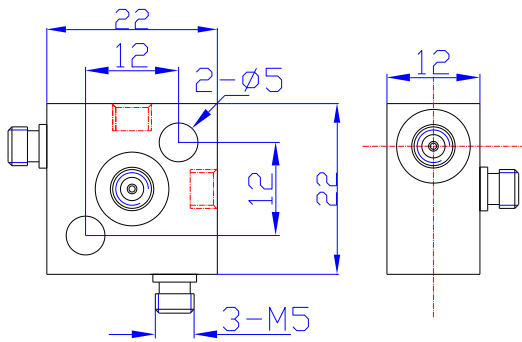

Model	MM242A-02
Sensitivity ($\pm 10\%$)	2 pC/g
Measurement Range	$\pm 2,000$ g
Transverse Sensitivity	$\leq 5\%$
Frequency Range (± 1 dB)	8,000 Hz
Resonant Frequency	~ 25 kHz
Non-linearity	$\leq 1\%$
Temperature Range	-54 \sim +150 $^{\circ}\text{C}$
Insulation Resistance	$\geq 10^{10}\Omega$
Sensing Element/Geometry	Ceramic/Shear
Size mm	As left figure
Weight	~ 37 g
Mounting	(2) $\Phi 5$ (Thru-hole)
Output Connector	(3) M5
Housing Material	Stainless Steel
Sealing	Epoxy Glue

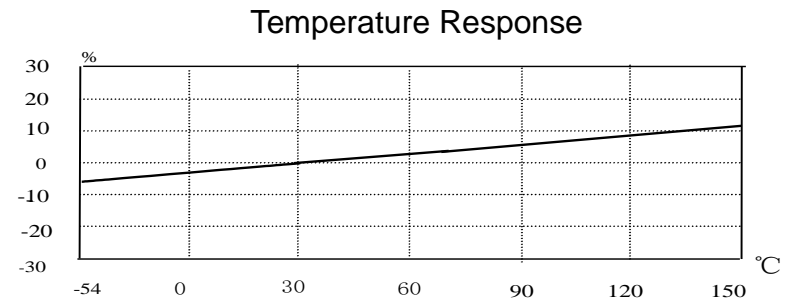
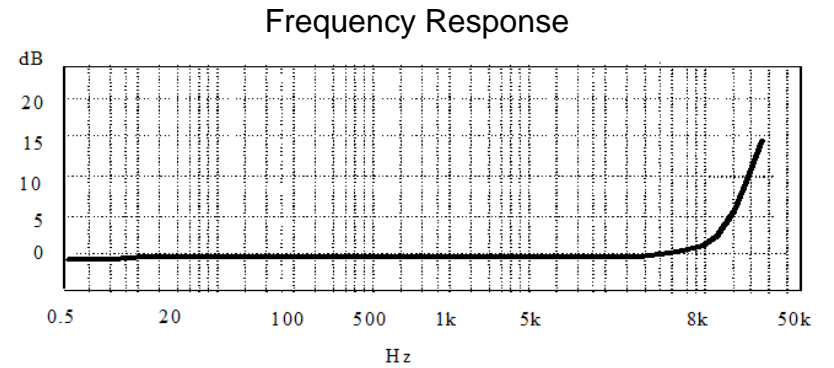

Metromatics

ABN: 47 007 346 287

Accessories

- 2M Low Noise Cable 3 ea
- Certificate of inspection 1ea + M5 Stud 2ea + M5 Screw 2ea

25 Flinders Parade, North Lakes QLD 4509, AUSTRALIA
www.metromatics.com.au sales@metromatics.com.au
 Brisbane: +61 7 3868 4255 | Sydney: +61 2 9460 4355
 Melbourne: +61 3 9872 4592 | Adelaide: +61 8 8343 8516

Remark